

# LES Push Travel Beam Trolley

## CTP Series

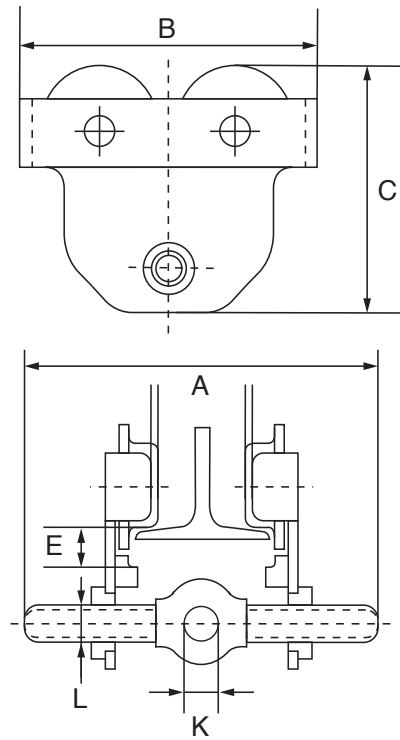

<b>Finish</b>	Black painted.
<b>Standard</b>	Meets the W.L.L. performance requirements of BS EN 13157.
<b>Safety Factor</b>	MBL equals 4 x W.L.L.
<b>Markings</b>	<b>LES</b> , <b>CE</b> , <b>UK</b> , mfg. date, capacity, beam range and serial number.
<b>Notes</b>	Lightweight robust construction. High grade steel sealed ball bearings for precise and smooth rolling. Side plates are produced with trolley wheel guards for additional safety.
<b>Certification</b>	2.1 DoC



Product Code	W.L.L. kgs	Beam Range mm	A mm	B mm	C mm	E mm	K mm	L mm	Weight kgs
LESPT0.5	500	50 - 220	300	200	175	20	30	25	5.6
LESPT1	1,000	58 - 220	300	238	186	30	35	30	8.9
LESPT2	2,000	66 - 220	310	270	215	30	47	40	14.8
LESPT3	3,000	74 - 220	320	320	268	30	58	48	23.8
LESPT5	5,000	90 - 220	330	365	306	32	70	60	37