

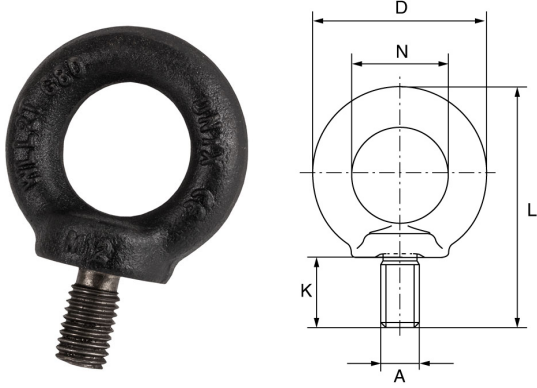



## Onyx Grade 80 Eyebolt – OXEB



# ONYX

- Grade 80 alloy steel, quenched and tempered.
- Matte black painted.
- DIN 580 according to size.
- -20°C up to +200°C.
- M.B.L. equals 4 x W.L.L.
- Marked with ONYX, CE, material grade, size and traceability code.
- W.L.L. is based upon in line lifting only (see WLL chart for angles).
- Certs available **2.1** **DoC**

Product Code	Part No.	W.L.L. t	A mm	D mm	K mm	L mm	N mm	Weight kgs	PDF
OXEB8	054-M8	0.8	8	36	15	51	20	0.06	

Product Code	Part No.	W.L.L. t	A mm	D mm	K mm	L mm	N mm	Weight kgs	PDF
OXEB10	054-M10	1	10	45	18	63	25	0.11	
OXEB12	054-M12	2	12	54	22	75	30	0.18	
OXEB16	054-M16	4	16	63	28	90	35	0.29	