

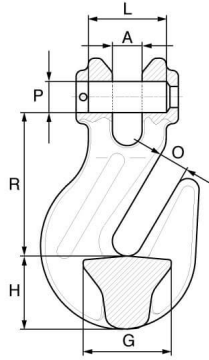

Grade 8 Clevis Grab Hook – G8CGH



KITO
weissenfels

- Alloy steel, quenched and tempered.
- Red painted finish.
- Conforms to BS EN 1677-1.
- Temperature range: -40 °C to +400 °C (Reductions in W.L.L apply).
- Clevis fitting enables direct connection to chain.
- Our grab hooks can be used as a shortening device without any reduction of SWL of the chain sling capacity.
- The 'T' shape in the bowl of the hook supports the chain and helps prevent possible deformation of the link when used as a shortening device.
- For correct safe use, the clevis grab hook must be assembled to the master link via three links of chain.
- Certification available **2.1** **3.1** **DoC**

Product Code	Chain Dia	Part No.	A	G	H	O	R	P x L
	mm		mm	mm	mm	mm	mm	mm

Product Code	Chain Dia	Part No.	A	G	H	O	R	P x L
	mm		mm	mm	mm	mm	mm	mm
G8CGH8	7/8	WA90	9	30	24	10	50	9 x 23
G8CGH10	10	WA91	13	44	31	13	72	13 x 31.5
G8CGH13	13	WA92	17	53	38	17	88	16 x 42
G8CGH16	16	WA93	21	64	44	20	102	21 x 51.5
G8CGH20	20	WA94	24	85	53	24	117	24 x 61.5
G8CGH22	22	WA95	26	97	62	27	139	26 x 72

Technical Data

Chain Dia	W.L.L.	M.P.F.	M.B.F.	Packing Qty	Weight
mm	t	kN	kN		kgs
7/8	2	50.3	80.4	40	0.3
10	3.15	78.5	126	16	0.75
13	5.3	133	212	10	1.4
16	8	201	322	7	2.5
20	12.5	314	503	5	4.3
22	15	380	608	1	6.4