

Grade 8 Swivel Self Locking Hook (106 Series) – G8SSLH

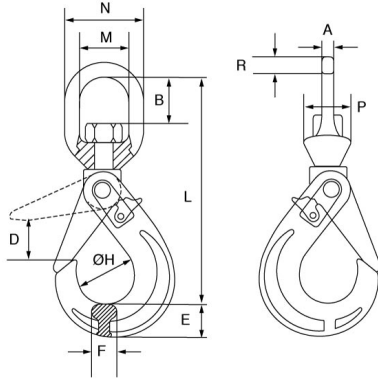

- Alloy steel, quenched and tempered.
- Red painted finish.
- Conforms to BS EN 1677-3.
- Temperature range -40°C to +400°C (Reductions in W.L.L apply).
- Large swivel eye makes assembly to wire/fibre rope slings (with thimbles) easier.
- Certification available **2.1** **3.1** **DoC**

Product Code	Chain Dia mm	Part No	A mm	B mm	D mm	E mm	F mm	H mm	L mm	M mm	N mm	P mm	R mm
G8SSLH6	6	106-6	10	34	27	20	16	35	162	38	63	39	12.5
G8SSLH8	7/8	106-7/8	10	31	33	26	20	45	188	38	63	39	12.5
G8SSLH10	10	106-10	12.5	40	44	35	27	58	228	47	79	48	16
G8SSLH13	13	106-13	15	50	54	41	30	71	285	58	96	60	19
G8SSLH16	16	106-16	17.5	65	66	53	35	84	337	72	120	60	24
G8SSLH20	20	106-20	22	68	77	64	48	99	372	82	136	82	27

Chain Dia	W.L.L.	M.P.F.	M.B.F.	Weight
mm	t	kN	kN	kgs
6	1.12	28.3	45.2	0.92
7/8	2	50.3	80.4	1.32
10	3.15	78.5	126	2.3
13	5.3	133	212	4.4
16	8	201	322	8
20	12.5	307	491	12