

## Grade 10 Eye Foundry Hook – G10EFH

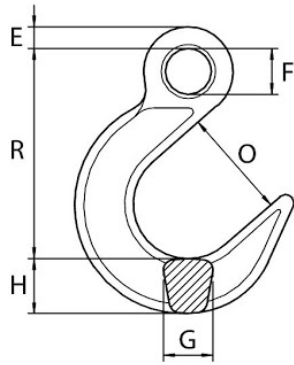

**KITO**  
weissenfels

- Grade 10 alloy steel, quenched and tempered.
- Grey painted finish.
- Meets the performance requirements of BS EN 1677-4 +25% of loads.
- Marked with material grade, manufacturers ID, size, product ID mark and traceability code.
- Certification available **2.1** **DoC**

Product Code	Part No.	Chain Dia mm	E mm	F mm	G mm	H mm	O mm	R mm
G10EFH8	FHE7-8	7/8	13.5	18	26	31	63	122.5
G10EFH10	FHE10	10	16	22	32	36	77	149
G10EFH13	FHE13	13	19	27	39	43	88	173.5
G10EFH16	FHE16	16	24	32	45	50	100	205
G10EFH20	FHE19-20	19/20	27	38	51	61	115	237

### Technical Data

Chain Dia	W.L.L.	M.P.F.	M.B.F.	Weight
mm	t	kN	kN	kgs
7/8	2.5	62.8	100	1.13
10	4	98.2	157	2
13	6.7	166	265	3.3
16	10	251	402	5.3
19/20	16	393	628	7.7